

EXISTING	PLAN	LEGEND	PROPOSED
—○—	—○—	FIRE HYDRANT	—○—
—○—	—○—	UTILITY POLE AND GUY WIRE	—○—
—○—	—○—	SIGN ON POST	—○—
—○—	—○—	FENCE	—○—
—○—	—○—	TIMBER RAIL	—○—
—○—	—○—	LIMITS OF DISTURBANCE	—○—
—○—	—○—	RETAINING WALL	—○—
—○—	—○—	CONCRETE CURB	—○—
—○—	—○—	STREET LINE	—○—
—○—	—○—	TREE	—○—
—○—	—○—	LIMITS OF CONSTRUCTION	—○—
—○—	—○—	PROPOSED 4000 WIDE TRAIL ROUTE	—○—
—○—	—○—	PROPOSED 3500 WIDE TRAIL ROUTE	—○—
—○—	—○—	PROPOSED FOOTPATH (LOCATION APPROXIMATE)	—○—
—○—	—○—	PROPERTY BOUNDARY	—○—
—○—	—○—	LIGHT STANDARD	—○—
—○—	—○—	UNDERGROUND CONDUIT	—○—

GENERAL NOTES

- ALL WORK SHALL BE CARRIED OUT IN ACCORDANCE WITH NSRBA/NSCEA MUNICIPAL SERVICES SPECIFICATIONS, HRM MUNICIPAL SERVICE SYSTEM GUIDELINES (RED BOOK) AND HW DESIGN AND CONSTRUCTION SPECIFICATIONS.
- GRADES ARE APPROXIMATE. FINISHED GRADE AND FINAL ALIGNMENT TO BE DETERMINED WITH HRM DURING CONSTRUCTION AND TO BE APPROVED IN FIELD BY ENGINEER.
- UTILITY INFORMATION IS APPROXIMATE ONLY. EXACT LOCATIONS SHALL BE DETERMINED IN FIELD BY THE CONTRACTOR PRIOR TO CONSTRUCTION.
- CONTRACTOR TO OBTAIN ALL NECESSARY PERMITS REQUIRED TO PERFORM WORK AND TO COMPLY WITH ALL PERMIT REQUIREMENTS AND CONDITIONS. CONTRACTOR TO COMPLY WITH ALL APPLICABLE ENVIRONMENTAL REGULATIONS.
- WHERE EXISTING CONDITIONS ARE SHOWN THEY ARE NOT NECESSARILY ACCURATE OR COMPLETE. THE CONTRACTOR SHALL CONFIRM ALL DIMENSIONS, ELEVATIONS AND LOCATIONS AND REPORT ANY DISCREPANCIES TO THE ENGINEER.
- THE CONTRACTOR SHALL CHECK AND VERIFY ALL DIMENSIONS BEFORE PROCEEDING WITH CONSTRUCTION. ANY ADJUSTMENTS WILL BE MADE BY THE ENGINEER AS NECESSARY.
- TRAFFIC SIGNS ARE NOT TO BE REMOVED OR REPLACED WITHOUT AUTHORIZATION FROM HRM TRAFFIC AUTHORITY AND THE ENGINEER.
- WORK IN THE IMMEDIATE AREA OF A NOVA SCOTIA COORDINATE MONUMENT MUST BE CARRIED OUT BY HAND. THE CONTRACTOR IS RESPONSIBLE FOR ANY COSTS RESULTING FROM MOVEMENT OF ANY MONUMENT.
- AT COMPLETION OF WORK REINSTATE AND SOD ALL DISTURBED SURFACES TO THE SATISFACTION OF THE ENGINEER.
- CONTRACTOR IS RESPONSIBLE FOR SETTING GRADES AND LAYOUT CONTROL. OBTAIN APPROVAL FROM ENGINEER PRIOR TO EXCAVATION.
- UTILITY POLE RELOCATION TO BE COORDINATED BETWEEN HRM AND NSPI.
- TREES SMALLER THAN 150 MAY BE CHIPPED ON SITE AND MULCH USED FOR FOOTPATH. ADDITIONAL BARK MULCH IS AVAILABLE (FREE OF CHARGE, BUT PICK UP AND DELIVERY IS NOT) FROM HRM.
- A MINIMUM OF 1.2M GRASSED BOULEVARD IS TO BE MAINTAINED ALONG ENTIRE TRAIL WITH THE EXCEPTION OF VERY STEEP AREA DIRECTLY ABOVE NSP BUILDING AND RETAINING WALL AND SECTION FROM SOUTH STREET TO STA 0+045 AND WHERE REQUIRED TO PRESERVE EXISTING TREES.
- TRAIL MAY BE REDUCED TO 3.5± TO PREVENT DAMAGE TO LARGE EXISTING TREES.
- CONTRACTOR SHALL CLEAR AND GRUB ALONG PROPOSED MULTI-USE TRAIL ALIGNMENT AS REQUIRED FOR CONSTRUCTION OF PAVED AREAS, PLANTINGS AND INSTALLATION OF FENCING AND ENGINEERED FILL.
- THE CONTRACTOR SHALL MEET WITH THE HRM ARBORIST, THE ENGINEER AND OTHER STAKEHOLDERS AS REQUIRED PRIOR TO CONSTRUCTION TO IDENTIFY WHICH TREES SHALL NOT BE CUT DURING CONSTRUCTION.
- ALL EXISTING SERVICES (IE VALVEBOXES, MANHOLES) SHALL BE EXTENDED/ADJUSTED TO THE PROPOSED GRADE AS REQUIRED.
- THE CONTRACTOR SHALL PROVIDE AN EROSION AND SEDIMENTATION CONTROL PLAN FOR APPROVAL BY HRM/ENGINEER PRIOR TO CONSTRUCTION. ALL SEDIMENTATION AND EROSION CONTROL FEATURES SHALL BE INSTALLED AND MAINTAINED IN ACCORDANCE WITH PROVINCIAL REGULATIONS. THE CONTRACTOR SHALL BE SOLELY RESPONSIBLE FOR ALL SEDIMENTATION AND EROSION CONTROL AT THE SITE.
- ALL CLEARED AND GRUBBED MATERIAL TO BE HAULED AWAY TO A SUITABLE DISPOSAL SITE.

SAFETY/PROCEDURES

- THE ENGINEER WILL NOT BE RESPONSIBLE FOR AND WILL NOT HAVE CONTROL OR CHARGE OF CONSTRUCTION MEANS, METHODS, TECHNIQUES, SEQUENCES OR PROCEDURES OR FOR SAFETY PRECAUTIONS AND PROGRAMS REQUIRED FOR THE WORK IN ACCORDANCE WITH THE APPLICABLE CONSTRUCTION SAFETY LEGISLATION, OTHER REGULATIONS OR GENERAL CONSTRUCTION PRACTICE. THE ENGINEER WILL NOT BE RESPONSIBLE FOR OR HAVE CONTROL OR CHARGE OVER THE ACTS OR OMISSIONS OF THE CONSTRUCTION MANAGER, CONTRACTOR, SUBCONTRACTORS OR THEIR AGENTS, EMPLOYEES OR OTHER PERSONS PERFORMING ANY OF THE WORK.
- THE CONTRACTOR SHALL HAVE COMPLETE CONTROL OF THE WORK AND SHALL EFFECTIVELY DIRECT AND SUPERVISE THE WORK SO AS TO ENSURE CONFORMANCE WITH THE CONTRACT DOCUMENTS. HE SHALL BE SOLELY RESPONSIBLE FOR CONSTRUCTION MEANS, METHODS, TECHNIQUES, SEQUENCES AND PROCEDURES AND FOR COORDINATING THE VARIOUS PARTS OF THE WORK UNDER THE CONTRACT.
- THE CONTRACTOR SHALL BE SOLELY RESPONSIBLE FOR CONSTRUCTION SAFETY AT THE PLACE OF WORK AND FOR COMPLIANCE WITH THE RULES, REGULATIONS, AND PRACTICES REQUIRED BY THE APPLICABLE CONSTRUCTION SAFETY LEGISLATION.
- THE CONTRACTOR SHALL INDEMNIFY AND HOLD HARMLESS, ENGINEER AND HRM IN CONNECTION WITH ANY INFRACTIONS OR ALLEGED INFRACTIONS OF THE CONTRACTOR WITH RESPECT TO ANY ACTS, CODES, REGULATIONS, ETC.
- THE CONTRACTOR SHALL BE THE CONSTRUCTOR UNDER THE NOVA SCOTIA OCCUPATIONAL HEALTH AND SAFETY ACT. NEITHER THE ENGINEER NOR HRM ARE CONSTRUCTORS UNDER THE ACT.

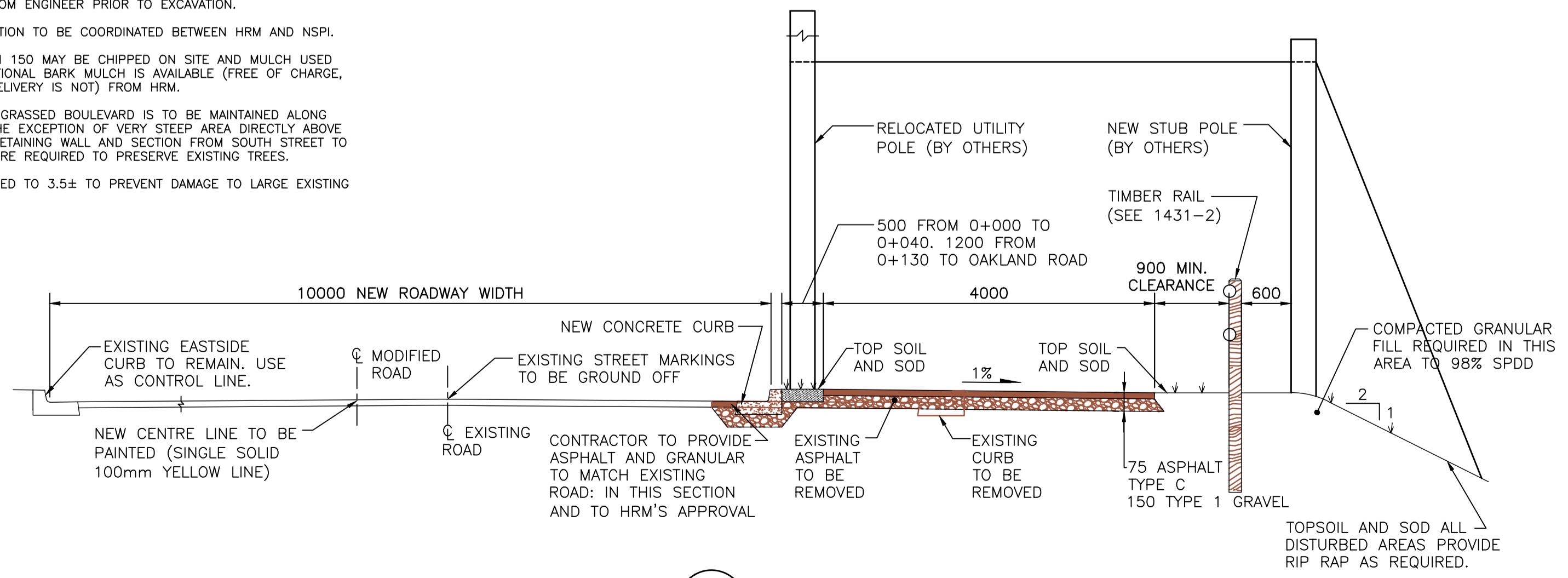

SECTION A BEAUFORT AVE. BETWEEN SOUTH AND OAKLAND
SCALE 1:50 NARROWED ROAD AND MULTIPURPOSE TRAIL

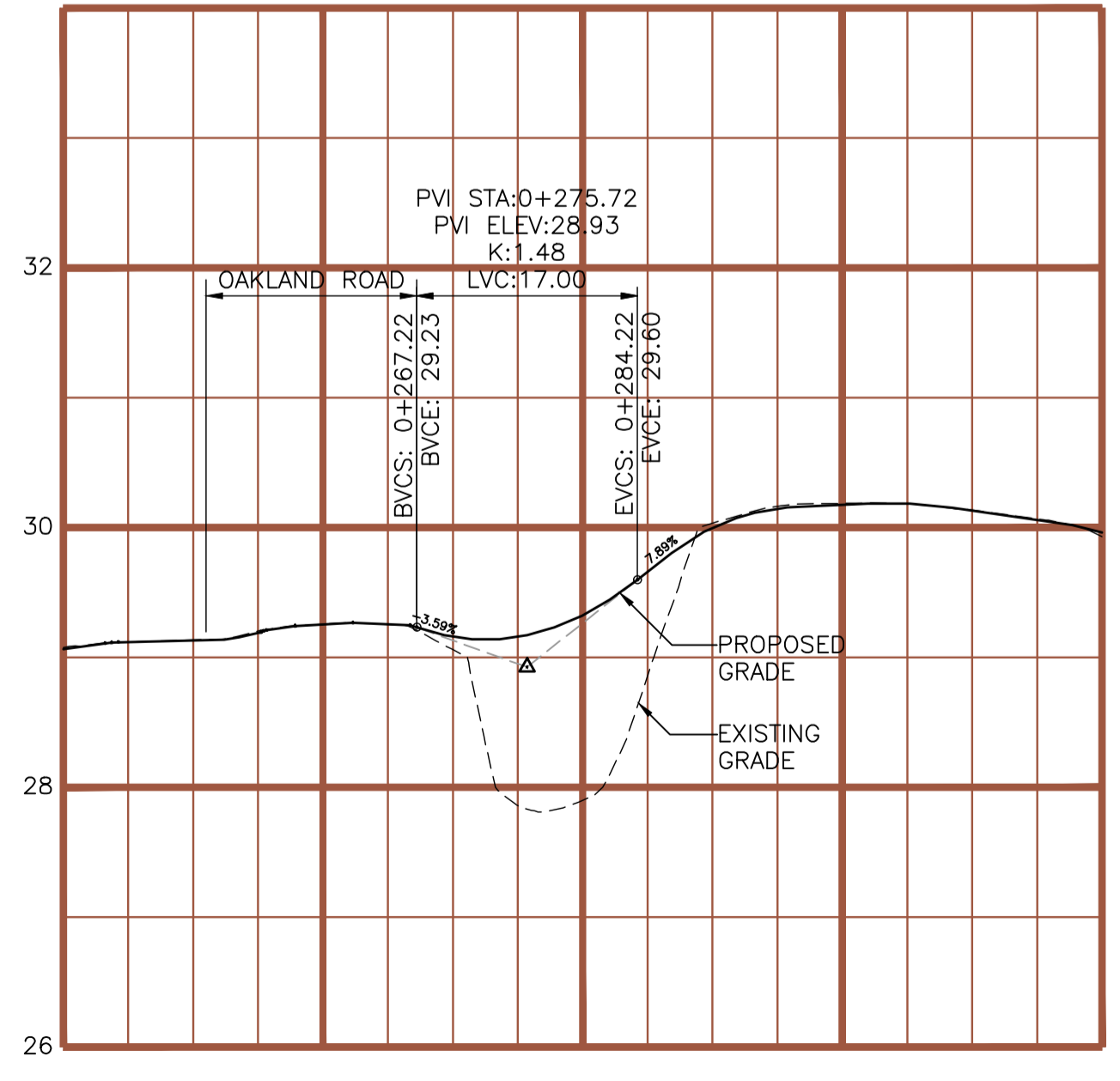

PROFILE 1
SCALE HOR-1:500
VER-1:50

No.	Date	Revision	Description	Appr'd
G	AUG. 5/09		ISSUED FOR CONSTRUCTION	
F	JUNE 4/09		ISSUED FOR HRM REVIEW	
E	JUNE 3/09		ISSUED FOR HRM REVIEW	
D	NOV. 29/07		ISSUED FOR PUBLIC INFORMATION SESSION	
C	NOV. 16/07		ISSUED FOR HUGA CONSULTATION	
B	OCT.18/07		ISSUED FOR HUGA CONSULTATION	
A	SEP.10/07		ISSUED FOR HRM CONSULTATION	



O'HALLORAN CAMPBELL
consultants limited
7071 Bayers Road
Suite 252
Halifax, Nova Scotia
B3L 2C2
Phone: (902)429-9826
Fax: (902)429-6457



HALIFAX URBAN GREENWAY

PLAN - MULTI-USE TRAIL AND FOOTPATH ALONG BEAUFORT AVE. SECTION 1

Date	APR. 27, 2005	Drawn	KLW	Project No.	09-169
Scale	1:500	Checked	ALB/MWM	Sheet	1 OF 4
Reference		Mgr. Design Services		Plan No.	1431-1
Surveyed		Dir. Eng. Services			